

Ring Plan for NTH TSHWANE

SATURDAY FCI

NB: Exhibitors may bench from **MIDDAY** on Friday 13th May 2022

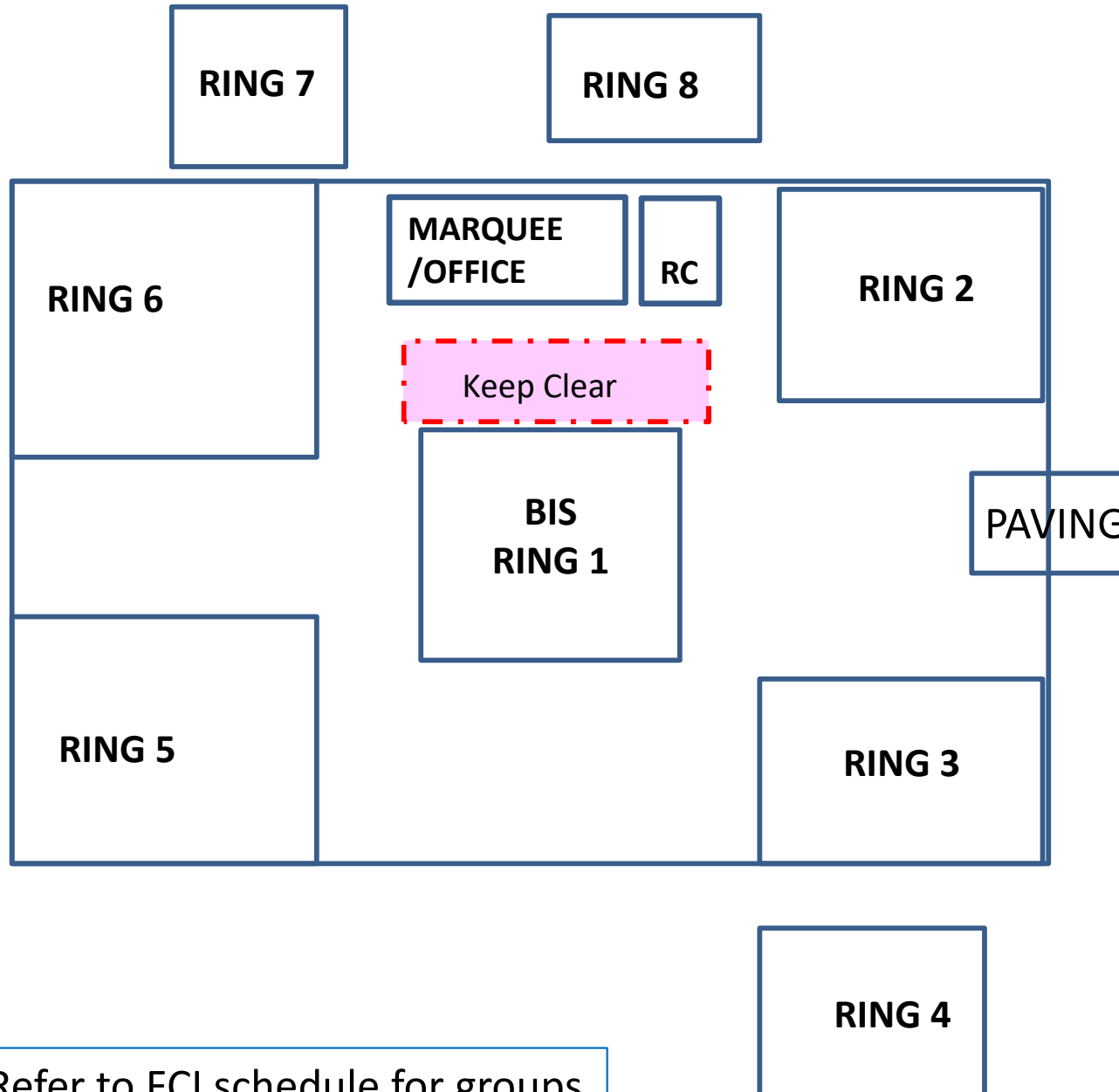

Refer to FCI schedule for groups your breed falls into.

- RING 1**
Group 4 & group
- RING 2**
Group 6 & group
- RING 3**
Group 10 & group
Part Group 5
Group 1 & group
- RING 4**
Part Group 2
Part Group 10
Group 9 & group
Part Group 3
Part Group 5
- RING 5**
Part Group 1
Part Group 6
Part Group 5 & Group
Part Group 9
- RING 6**
Part Group 5
Part Group 8
Part Group 1
Group 2 & Group
- RING 7**
Group 7 & group
Group 8 & group
- RING 8**
Bull Terriers & Mini Bull Terriers
Bal Group 3 & group

Ring Plan for NTH TSHWANE CH SHOW 2 NOT BEFORE 10AM 14th MAY 2022

NB: Exhibitors may bench from **MIDDAY** on Friday 13th May 2022

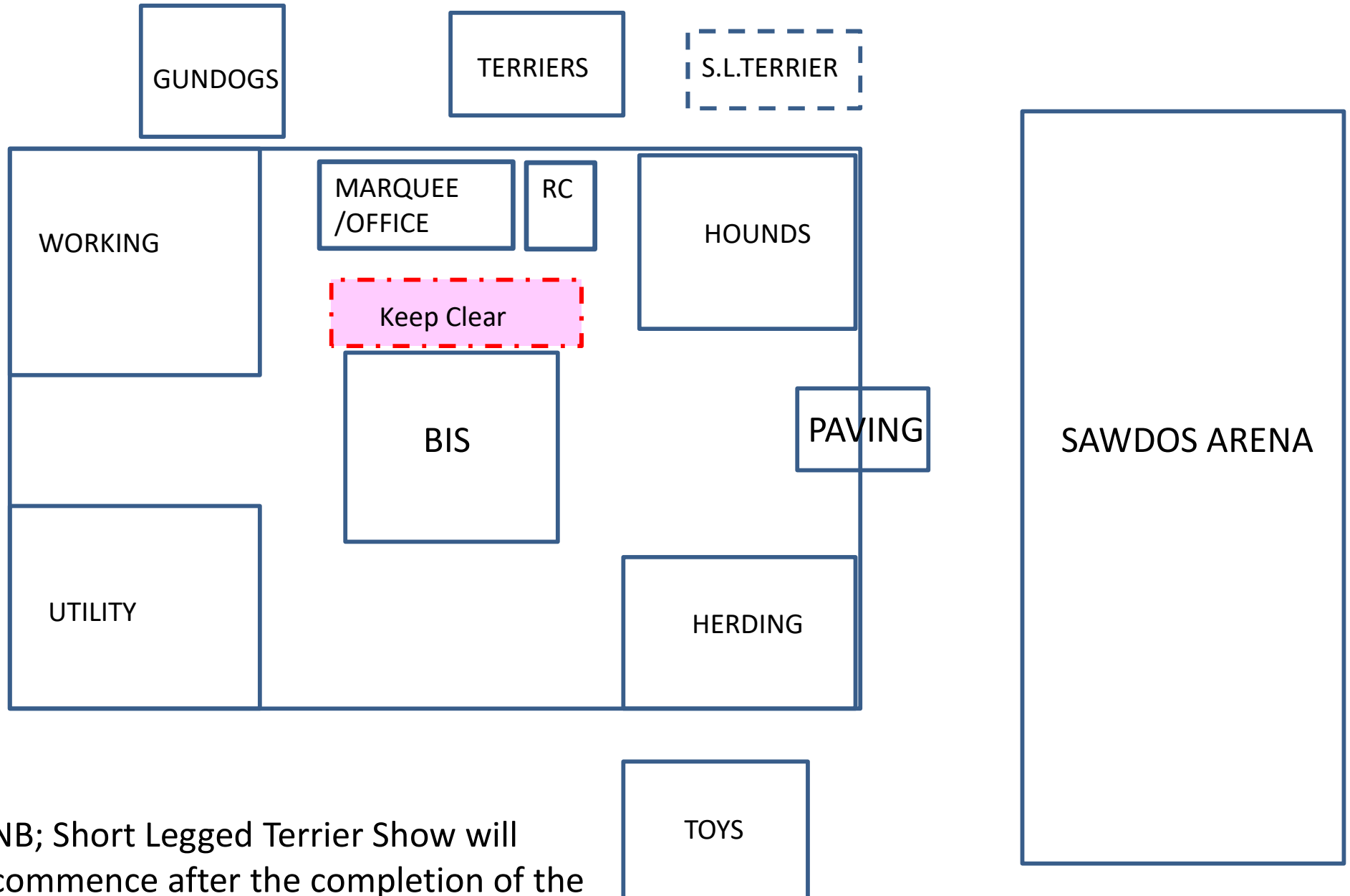

NB; Short Legged Terrier Show will commence after the completion of the Terrier group at Nth Tshwane Ch Show.

Ring Plan for NTH TSHWANE CH SH 1

Sunday 15th MAY 2022

NB: Exhibitors may bench from **MIDDAY** on Friday 13th May 2022

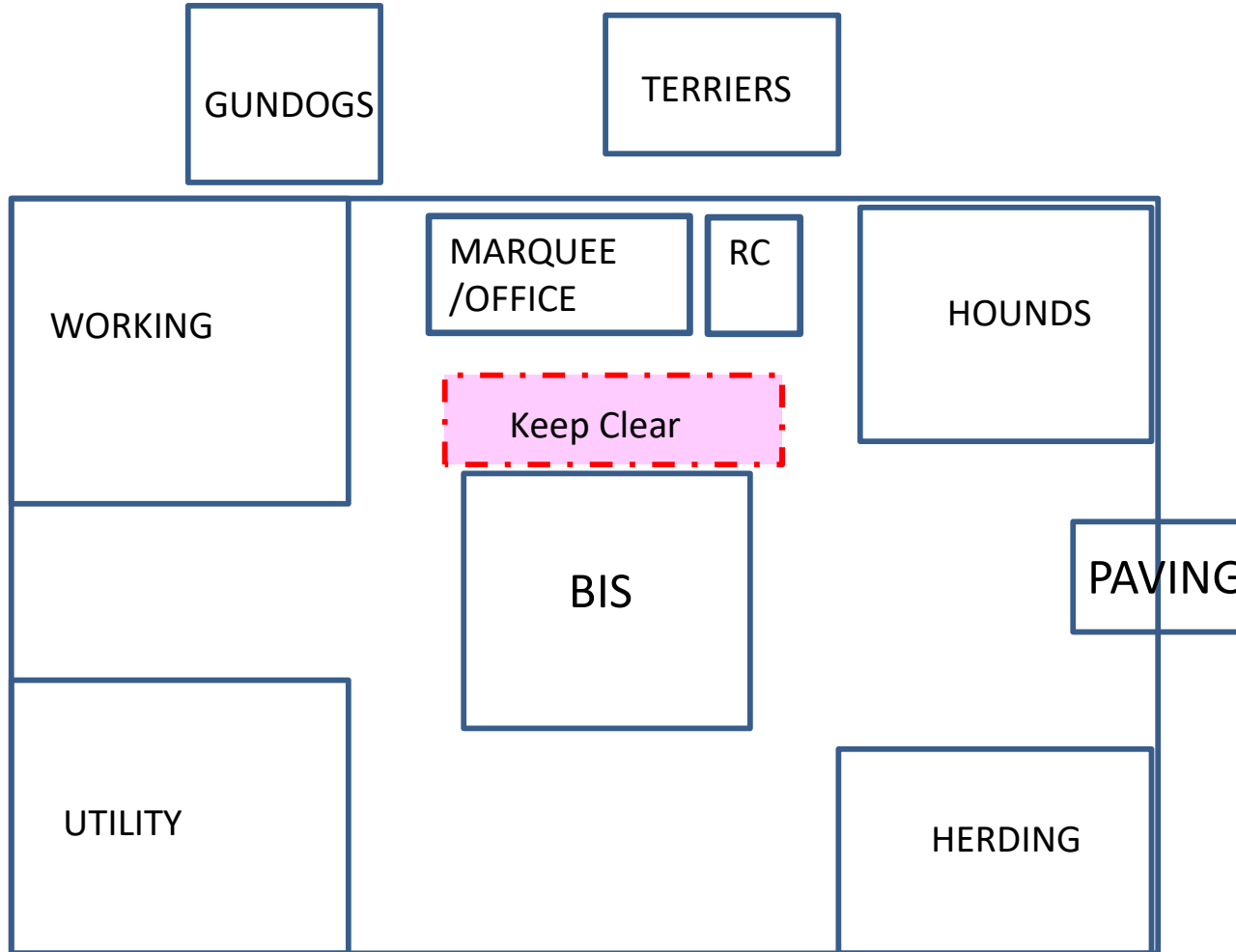

SAWDOS ARENA

DISCIPLINES
AGILITY CONTACT
AGILITY NON CONTACT
DOG JUMPING
FLYBALL

SA Bulldog Club - Utility Ring
Witwatersrand Corgi Club - Herding Ring

TOYS